

SALIVA PCR TEST INSTRUCTIONS

Follow these instructions carefully.
Use only materials provided in your kit to collect and store your sample.



1 If you feel your mouth is dry, start with massaging both cheeks. Do **not** drink any water just before collecting specimen.



2 Wash your hands with hand sanitizer or use wipes provided in the bag.



3 Open the packaging and **APPLY THE BARCODE DECAL TO THE COLLECTION TUBE.**



4 Collect as much saliva in your mouth as you can.

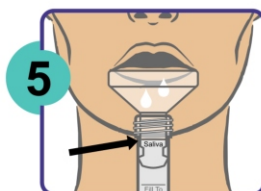

5 Spit into funnel and collect enough liquid saliva to reach the line that says "saliva".

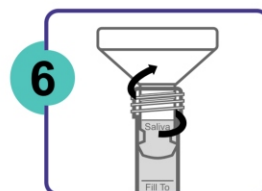

6 Unscrew the funnel and place it back in the ziplock bag provided for garbage.



covid19-diagnostics.com

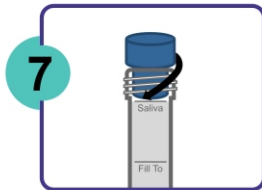

Screw on the blue cap.

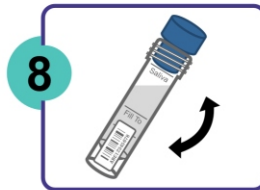

Shake the specimen for 5 seconds.



Text us at **847-641-4187** to let us know you have completed the collection. Please remain in your vehicle. One of our testing techs will arrive shortly.



Use the sanitary wipes provided in the bag to wash your hands.



Return the specimen kit along with all packaging and garbage to the technician.



You will receive an email when your results are available.

TEXT US AT 847-641-4187 IMMEDIATELY FOLLOWING SPECIMEN COLLECTION

WHAT TO DO WHILE YOU WAIT FOR YOUR RESULTS

Whether you are infected or not, wear a face mask, keep a distance of 6 feet or more from others, wash your hands often, and avoid touching your face.

Please keep in mind that SARS-CoV-2 (COVID-19) diagnostic tests are not perfect. No test is. If they were perfect, a positive test would mean that someone carries the virus and a negative test would mean that they do not. With imperfect tests, a negative result means only that a person is less likely to be infected. Thus, we ask that you consider risk factors and individual scenarios and not completely rely on the test results to influence your behavior.